



**Retail Redevelopment**  
4,000 - 48,582 RSF Available

**750 White Plains Road**  
Eastchester, New York





# A Built-In Walkable Environment

The site is directly adjacent to Vernon Hills Shopping Center. It is within walking distance to a wealth of food & beverage, service retail, entertainment and wellness/fitness options.

## RETAIL & SERVICES



American Eagle Outfitters, Athleta, Banana Republic, Barnes & Noble, Gap, Jos. A. Bank, Lenscrafters, Loft, Talbots, The Children's Place, West Elm, Chase, Citibank, Verizon

## FOOD & BEVERAGE



AB's Cafe & Grill, Fig & Olive, Starbucks, Fresh Market, Green's Natural Foods, Trader Joe's, Tuttabella Trattoria

## HEALTH & WELLNESS



Columbia University Medical Center, CVS Pharmacy, Equinox, New York Presbyterian Hospital, New York Sports Club, Susan Marlowe



# Aerial

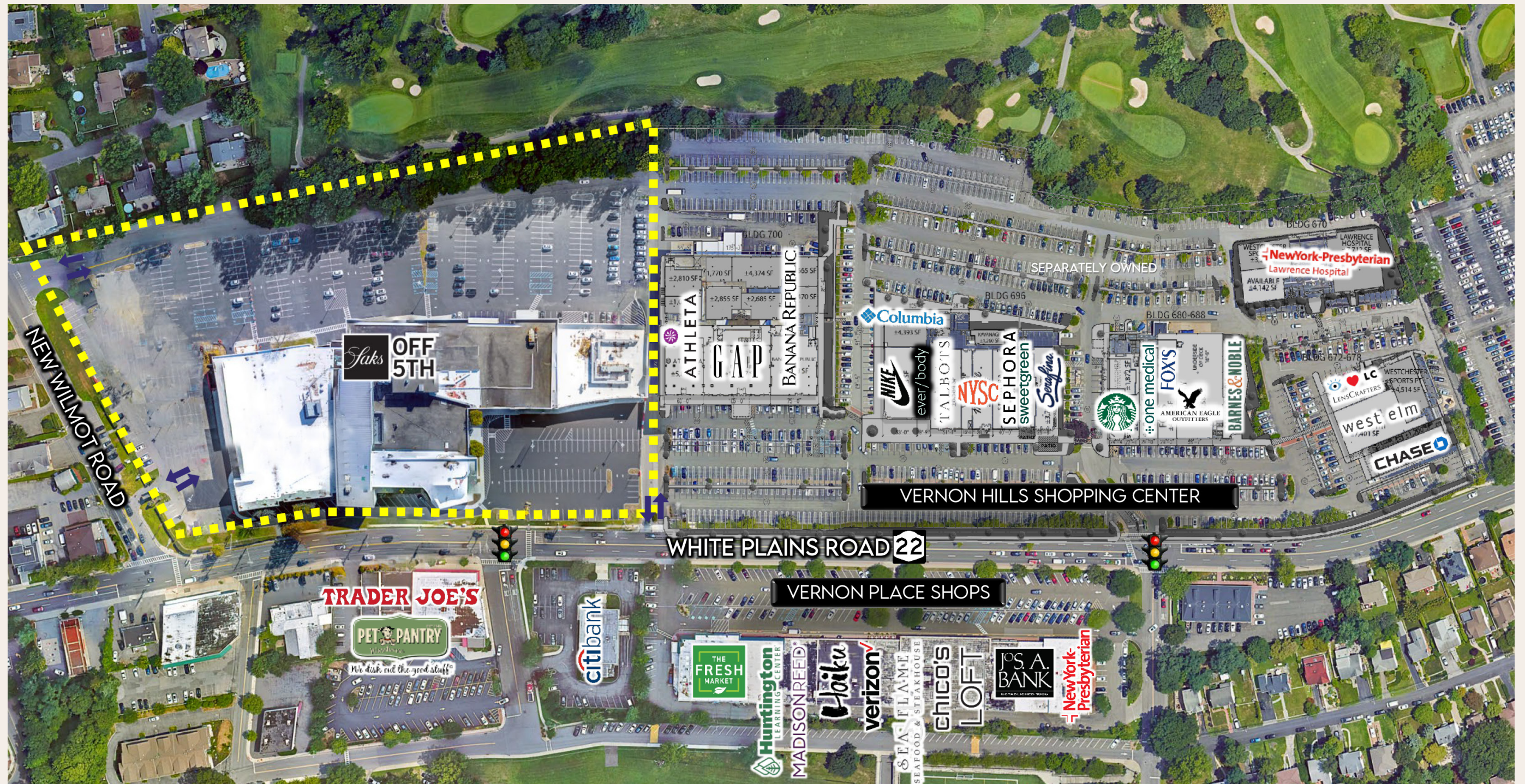

# EASTCHESTER, NY

750 SQUARE ▪ 750 WHITE PLAINS ROAD (ROUTE 22)

LEVEL 1



19,293 RSF  
AVAILABLE

# EASTCHESTER, NY

750 SQUARE ▪ 750 WHITE PLAINS ROAD (ROUTE 22)

LEVEL 2

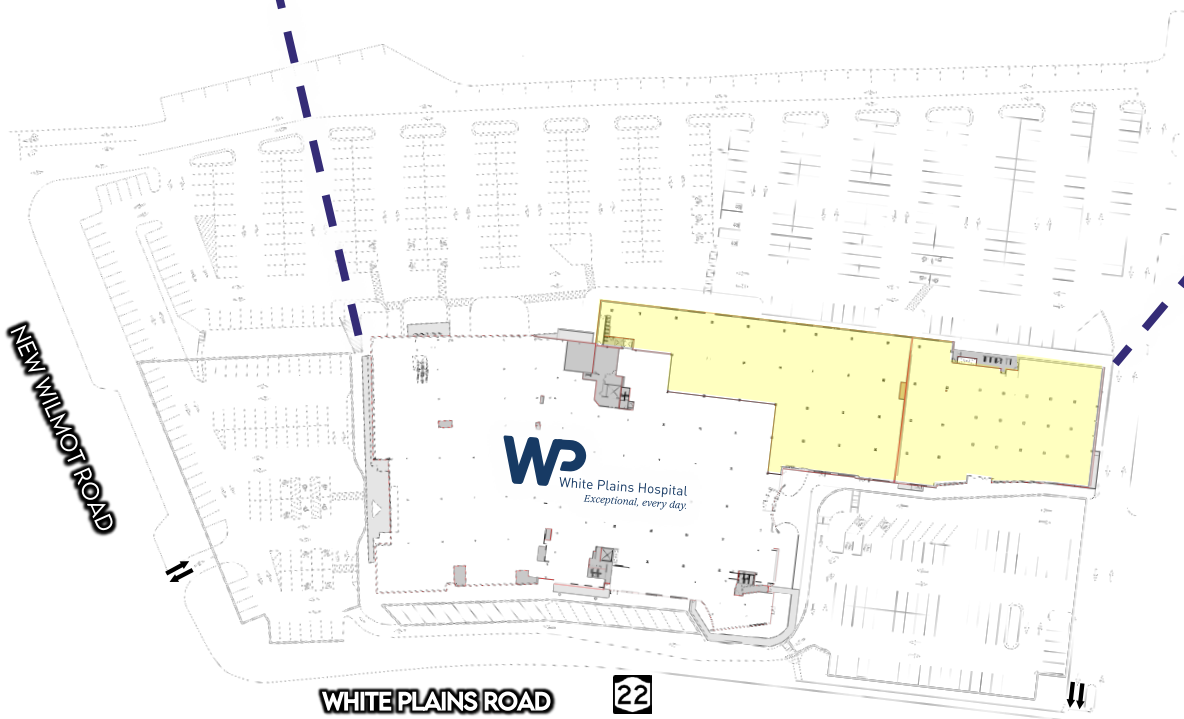
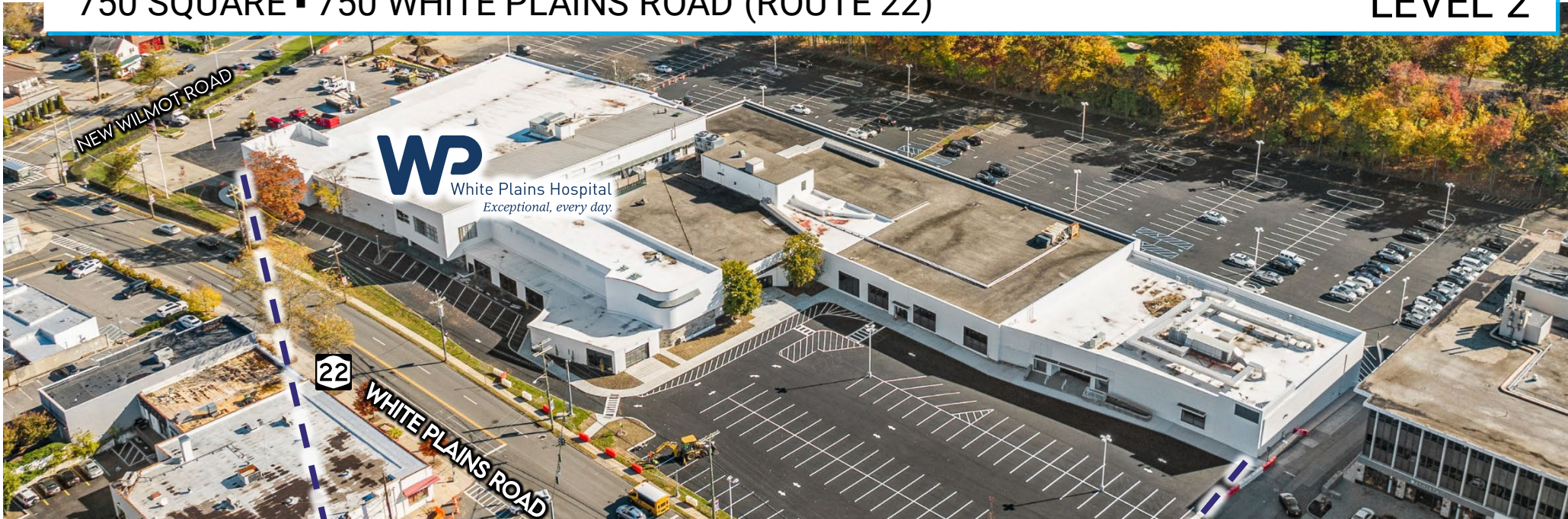

4,000 - 48,582  
RSF AVAILABLE

# EASTCHESTER, NY

750 SQUARE ▪ 750 WHITE PLAINS ROAD (ROUTE 22)

Level 3

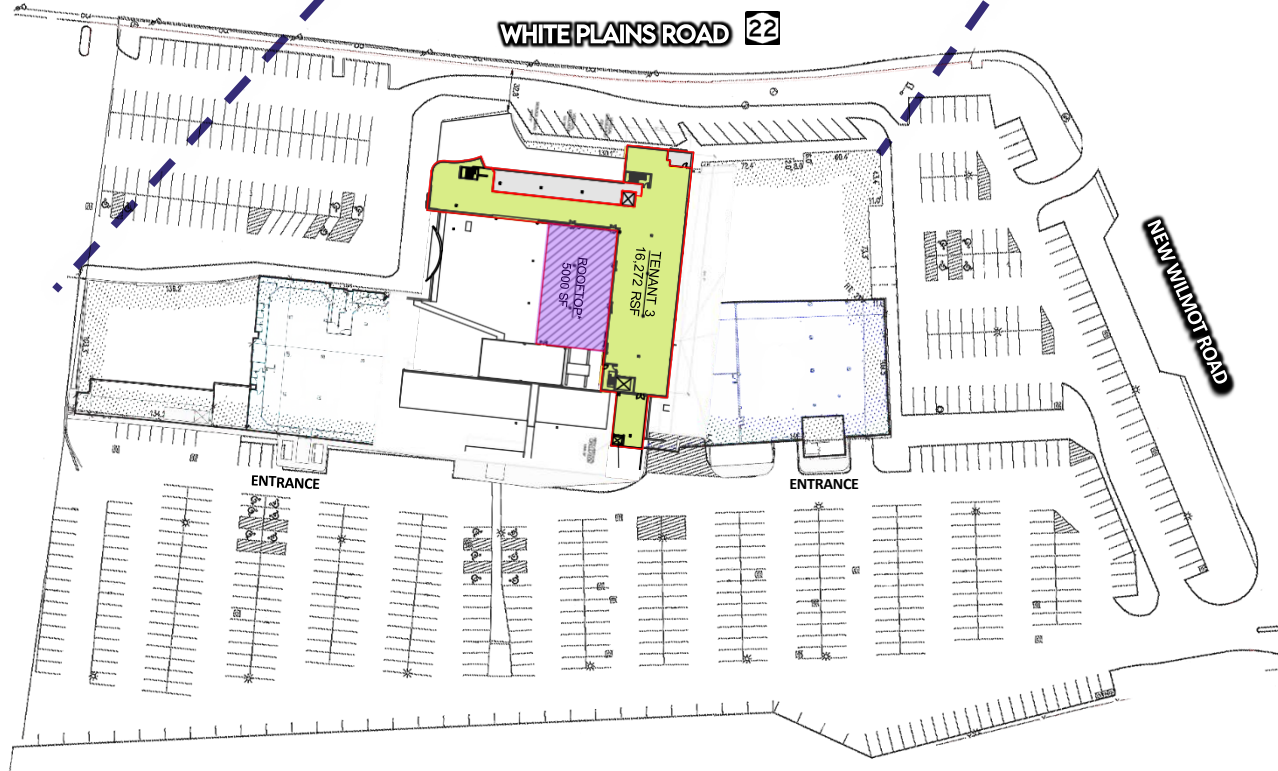

16,380 RSF  
AVAILABLE

# Renderings

Proposed access rooftop vestibule  
5,000 SF Outdoor Patio







# Leasing Contact

**Alexia MacIntosh**  
Hudson's Bay Company  
alexia.macintosh@hbc.com  
929-989-6925

